

WERMA MC55 High

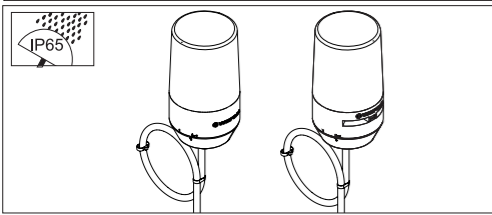

- DE Anschluss **ausschließlich** durch ausgebildete Elektro-Fachkräfte.
- GB Electrical connection is to be made by trained electrical specialists **only**.
- FR Le branchement doit **uniquement** être effectué par des professionnels.
- IT Il collegamento deve essere eseguito **solo** da elettricisti specializzati.
- ES La conexión **sólo** debe ser realizada por electricistas debidamente formados.
- PT A ligação deve ser feita **exclusivamente** por profissional elétrico especializado.
- NL De aansluiting mag **enkel** gebeuren door erkende vakmensen.
- CZ Připojení smí **provádět** pouze kvalifikovaný personál.
- PL Podłączenie **wyłącznie** przez specjalistów-elektryków.
- FI Liittäminen kuuluu **ainoastaan** koulutettujen sähköalan ammattilaisten tehtäviin.
- RU Подключение проводится только специалистом-электриком.
- TR Bağlantı **sadece** eğitimli elektrik teknisyenleri tarafından yapılmalıdır.
- CN 布线需由专业电工执行。

UK WERMA (UK) Ltd.,
CA NN15 6FD,
United Kingdom

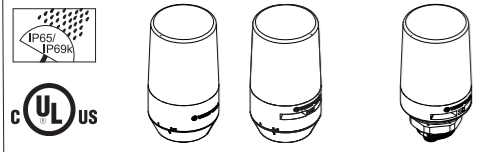
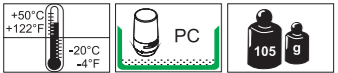

WERMA Signaltechnik GmbH + Co. KG
D-78604 Rietheim-Weilheim
Telefon +49 (0)7424 / 9557-0
Telefax +49 (0)7424 / 9557-44
info@werma.com
www.werma.com

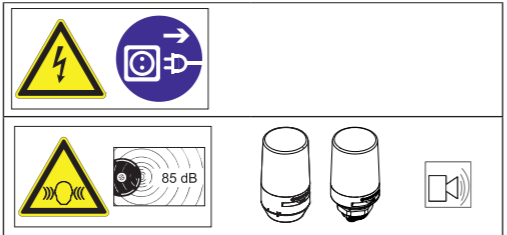

LED RGB Permanent M12	240 600 01	10 - 30 V=	I ≤120 mA I ₀ <1000 mA
LED RGB Permanent M12	240 600 02	10 - 30 V=	I ≤125 mA I ₀ <1000 mA
LED RGY Permanent M12	240 600 03	24 V=	I ≤42 mA no inrush
LED RGY Permanent M12	240 600 04 240 600 12	24 V=	I ≤60 mA I ₀ <750 mA
LED RGB Permanent Cable	240 600 05	10 - 30 V=	I ≤120 mA I ₀ <1000 mA
LED RGB Permanent Cable	240 600 06	10 - 30 V=	I ≤125 mA I ₀ <1000 mA
LED RGY Permanent Cable	240 600 07	24 V=	I ≤42 mA no inrush
LED RGY Permanent Cable	240 600 08	24 V=	I ≤60 mA I ₀ <750 mA

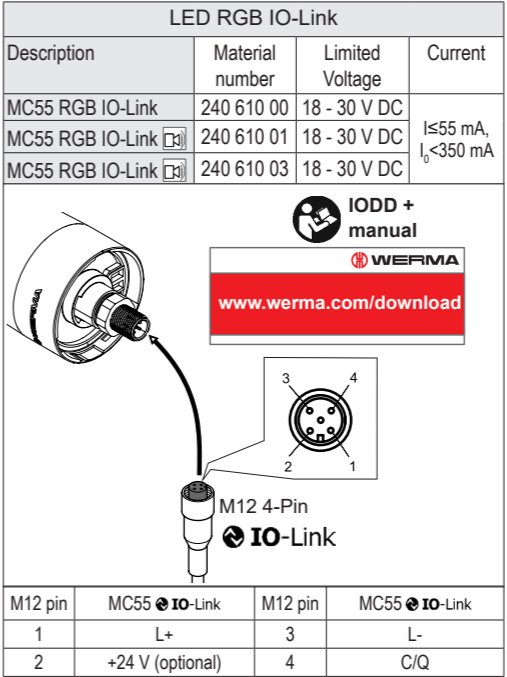
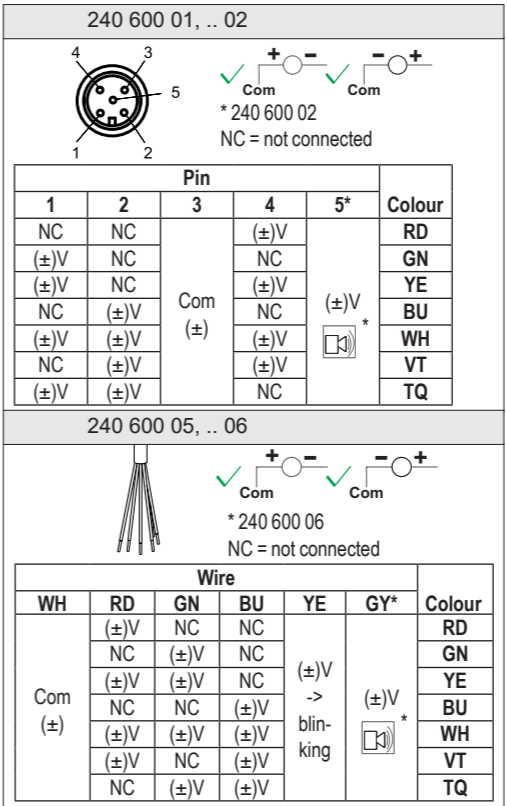
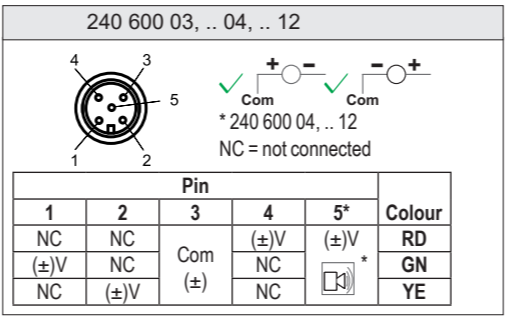
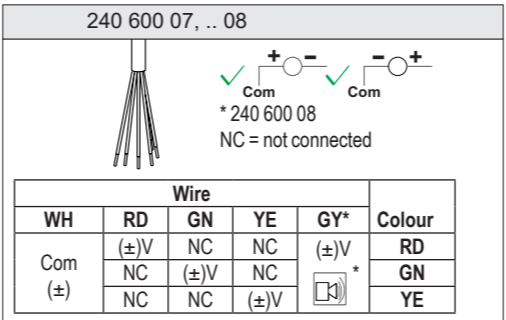
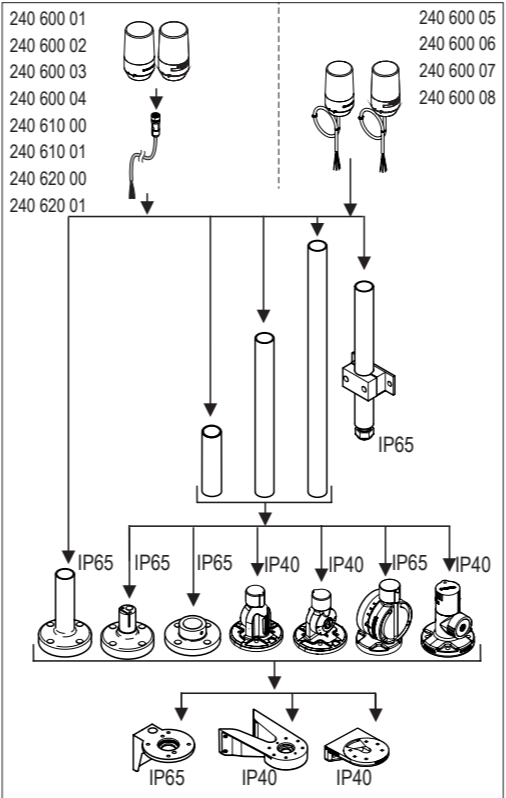
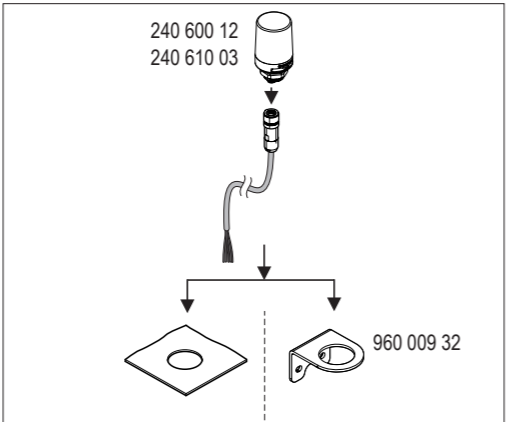

LED RGB Smart

Description	Material number	Limited Voltage	Limited Current	Max. Load (Switch Mode)
MC55 RGB Smart	240 620 00	24 V DC	60 mA	200 mA
MC55 RGB Smart	240 620 01	24 V DC	75 mA	200 mA

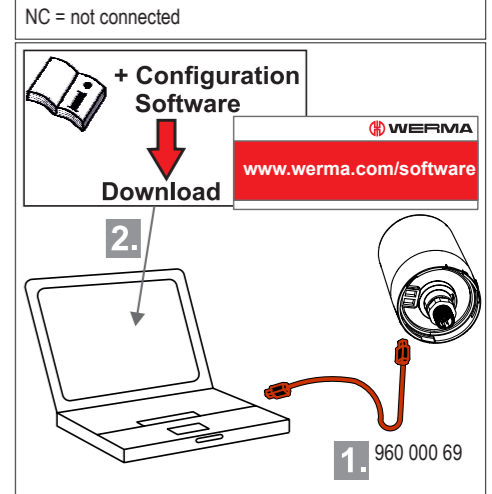
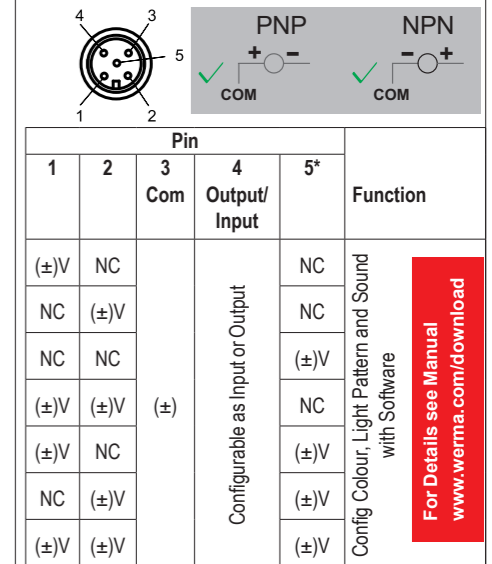

For Details see Manual
www.werma.com/download

1
1a: 240 600 12, 240 610 03
1b: + 960 009 32

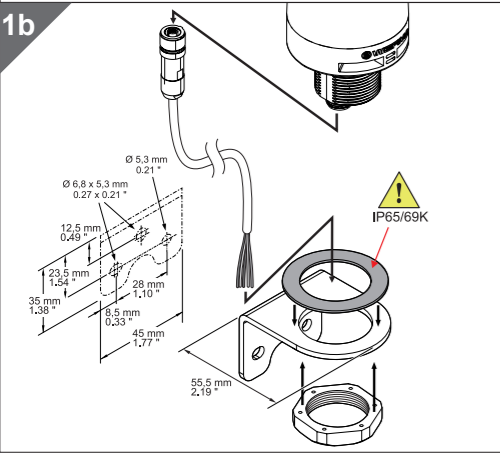
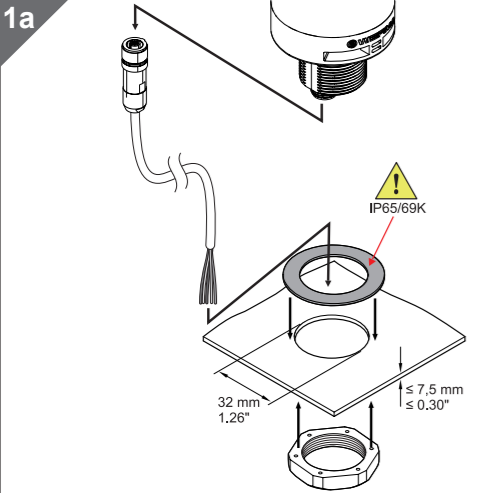

2-4
2-4: 240 600 01, ... 08
4a:
4b: + 960 000 01, + 960 009 01
4c: + 960 009 17, + 960 009 18, + 960 009 19
4d: + 975 849 90, 960 000 64, 960 000 30
975 849 91, 975 840 90, 975 849 11, 975 840 91
960 009 12, 975 840 10

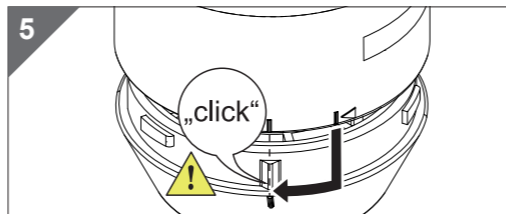
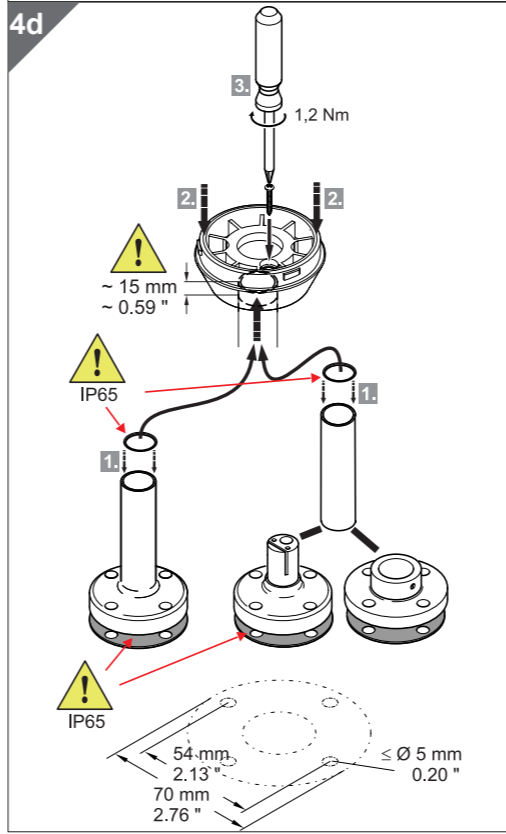
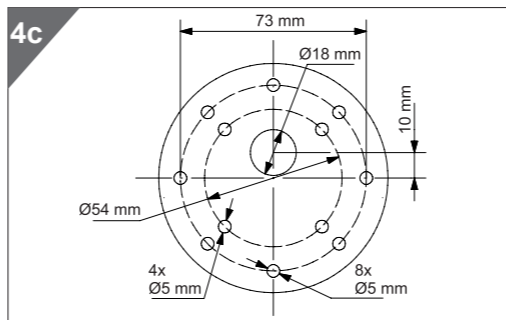
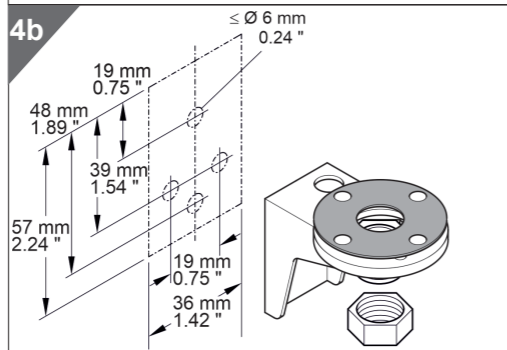
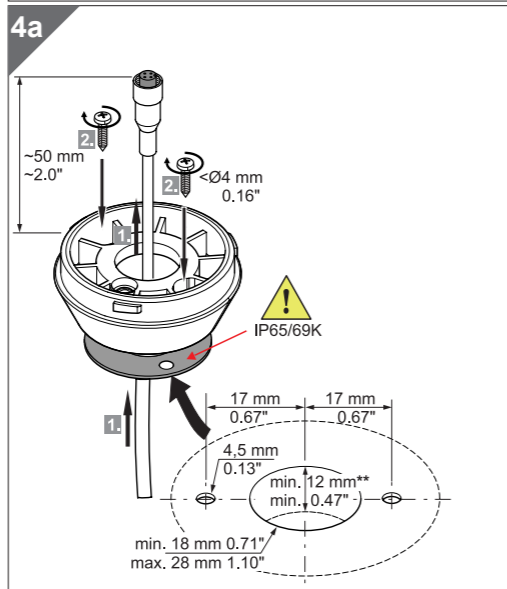
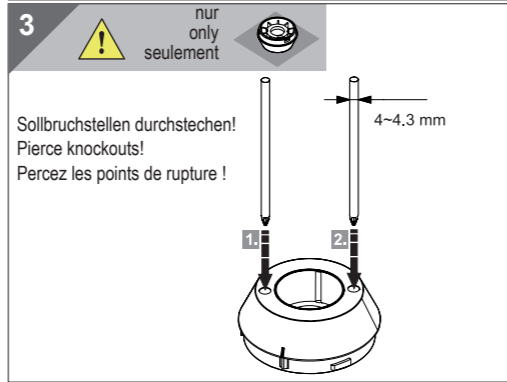
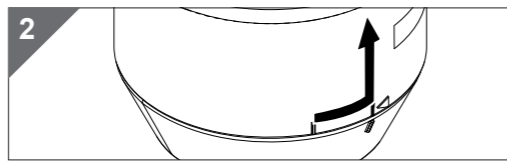

150000005646_AA
310.240.005 © DE



WERMA Signaltechnik GmbH + Co. KG
Dürbheimer Straße 15
78604 Rietheim-Weilheim / Germany

**Marking of Hazardous Substances
有害物质标识**

WERMA article number 伟马伟德物料号:
240 600 01, 240 600 02, 240 600 03, 240 600 04, 240 600 05, 240 600 06, 240 600 07, 240 600 08, 240 600 09, 240 600 10, 240 600 11, 240 600 12, 240 600 13, 240 600 15

According to the SJ/T 11364-2014 Standard of the People's Republic of China for the Electronic Industry
本表格依据中华人民共和国 SJ/T 11364-2014 的规定编制

Component Name 部件名称	Lead 铅(Pb)	Mercury 汞(Hg)	Cadmium 镉(Cd)	Hexavalent Chromium 六价铬(Cr(VI))	Polybrominated biphenyls 多溴联苯(PBB)	Polybrominated diphenyl ethers 多溴二苯醚(PBDE)
Plastic parts 塑料件	0	0	0	0	0	0
Label 标签	0	0	0	0	0	0
PCB and its electric components 印刷电路板及其电子元件	X*	0	0	0	0	0
M12 plug and cable M12 插头和电缆	X*	0	0	0	0	0
Cable tie 扎带	0	0	0	0	0	0

This table was developed according to the provisions of SJ/T 11364-2014
本表格依据 SJ/T 11364-2014 的规定编制

O: The content of such hazardous substance in all homogeneous materials of such component is **below** the limit required by GB/T 26572-2011.
表示该有害物质在该部件所有均质材料中的含量均在 GB/T 26572-2011 规定的限量要求以下。

X: The content of such hazardous substance in all homogeneous materials of such component is **beyond** the limit required by GB/T 26572-2011.
表示该有害物质在该部件的某一均质材料中的含量超出 GB/T 26572-2011 规定的限量要求。

Enterprises may further explain the technical reasons for ticking "X" in the table above according to their actual situation herein.
企业可在此处, 根据实际情况对上表中打"X"的技术原因进行进一步说明。

*Exemptions according to EU RoHS 2011/65 Annex III and IV might be applied
*欧盟 RoHS 2011/65 附件 III 和 IV 的豁免可能适用

■ Restricted substances beyond limit required by GB/T 26572-2011.
限制物质的含量超过 GB/T 26572-2011 规定限制

EFUP (Environment Friendly Use Period) 环保使用期限:
限制物质的含量超过 GB/T 26572-2011 规定限制



ppa. D. Kensy
Director R&D



WERMA Signaltechnik GmbH + Co. KG
Dürbheimer Straße 15
78604 Rietheim-Weilheim / Germany

**Marking of Hazardous Substances
有害物质标识**

WERMA article number 伟马伟德物料号:
240 600 00, 240 600 02, 240 600 04, 240 600 06, 240 600 01, 240 600 03, 240 600 05, 240 600 07, 240 600 09, 240 600 11, 240 600 13, 240 600 15

According to the SJ/T 11364-2014 Standard of the People's Republic of China for the Electronic Industry
本表格依据中华人民共和国 SJ/T 11364-2014 的规定编制

Component Name 部件名称	Lead 铅(Pb)	Mercury 汞(Hg)	Cadmium 镉(Cd)	Hexavalent Chromium 六价铬(Cr(VI))	Polybrominated biphenyls 多溴联苯(PBB)	Polybrominated diphenyl ethers 多溴二苯醚(PBDE)
Plastic parts 塑料件	0	0	0	0	0	0
Label 标签	0	0	0	0	0	0
PCB and its electronics components 印刷电路板及其电子元件	X*	0	0	0	0	0
M12 plug and cable M12 插头和电缆	X*	0	0	0	0	0
Cable tie 扎带	0	0	0	0	0	0

This table was developed according to the provisions of SJ/T 11364-2014
本表格依据 SJ/T 11364-2014 的规定编制

O: The content of such hazardous substance in all homogeneous materials of such component is **below** the limit required by GB/T 26572-2011.
表示该有害物质在该部件所有均质材料中的含量均在 GB/T 26572-2011 规定的限量要求以下。

X: The content of such hazardous substance in all homogeneous materials of such component is **beyond** the limit required by GB/T 26572-2011.
表示该有害物质在该部件的某一均质材料中的含量超出 GB/T 26572-2011 规定的限量要求。

Enterprises may further explain the technical reasons for ticking "X" in the table above according to their actual situation herein.
企业可在此处, 根据实际情况对上表中打"X"的技术原因进行进一步说明。

*Exemptions according to EU RoHS 2011/65 Annex III and IV might be applied
*欧盟 RoHS 2011/65 附件 III 和 IV 的豁免可能适用

■ Restricted substances beyond limit required by GB/T 26572-2011.
限制物质的含量超过 GB/T 26572-2011 规定限制

EFUP (Environment Friendly Use Period) 环保使用期限:
限制物质的含量超过 GB/T 26572-2011 规定限制



ppa. D. Kensy
Director R&D

Rietheim 里森姆 26.06.2025
i.V. 授权 D. Kensy
Director R&D 研发总监