

Electromechanical Audible Signal Devices / AC Installation Buzzers 338  
**Buzzer EM Contin. tone 230VAC**

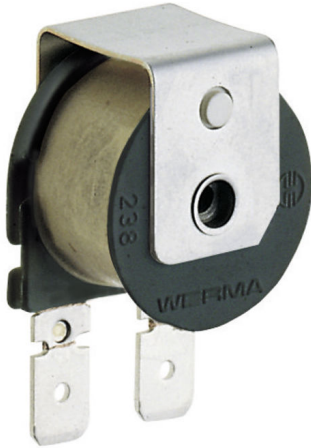

**Part No.:** 338.373.28

#### MECHANICAL DATA

Length	34 mm
Width	23 mm
Height	19 mm
Diameter	23 mm
Materials	PA-GF
Housing colour	Black
Protection category	IP00
Connection	Flat plug
Type of fixing	Built-in mounting
Service life optical	300 h minimum
Acoustic service life	300 h minimum
Working temperature minimum	-20°C
Working temperature maximum	+60°C
Weight with packaging	26 g
Product weight	26 g

#### ELECTRICAL DATA

Operating voltage	230V
Operating voltage type	AC
Operating voltage type	50Hz
Operating voltage tolerance	+/- 10%
Rated operational voltage	230 VAC
Rated operational current	24 mA
Rated inrush current	<500mA
Pollution degree	2

#### ACUSTICAL DATA

Volume/dB(max) at 1m distance	75,0 dB dB(A)
Acoustic signal image	Continuous tone
Audio frequency	100 Hz



For additional installation and mounting information, refer to the appropriate user guide at [www.werma.com](http://www.werma.com). This printed copy is for information only and is subject to alteration.

Electromechanical Audible Signal Devices / AC Installation Buzzers 338  
**Buzzer EM Contin. tone 230VAC**

**DRAWING**

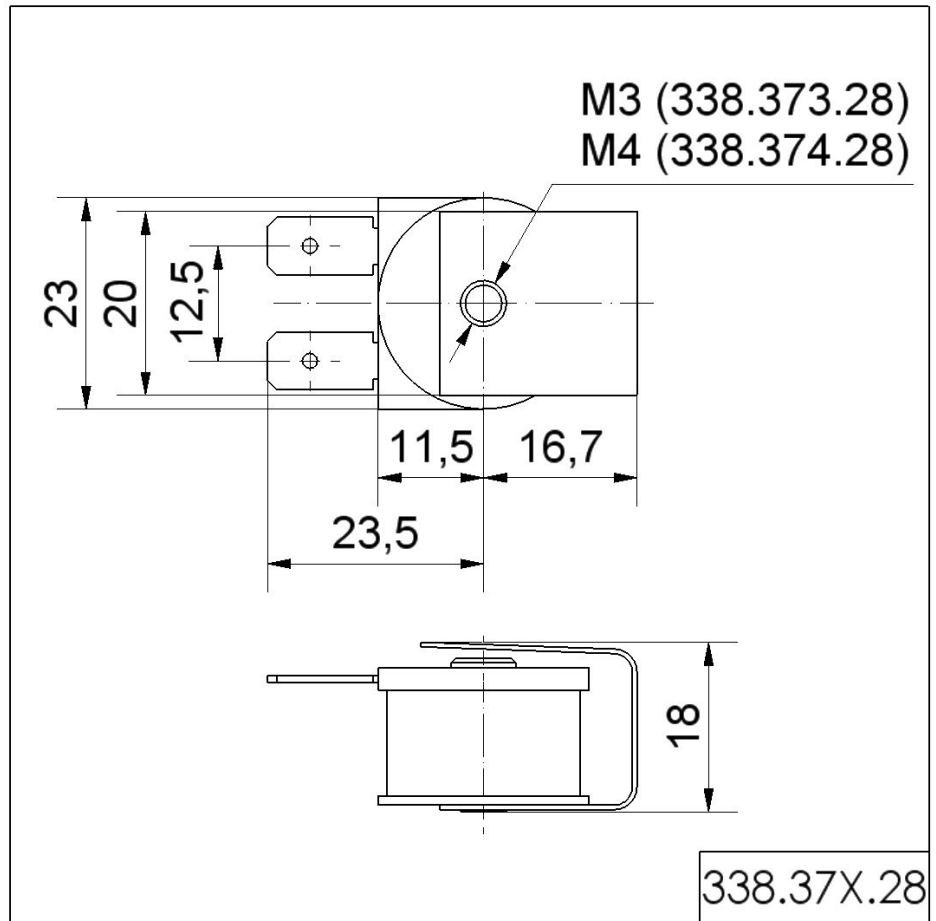

! For additional installation and mounting information, refer to the appropriate user guide at [www.werma.com](http://www.werma.com). This printed copy is for information only and is subject to alteration.